



SERVICE BULLETIN

QUALITY INFORMATION ANALYSIS
OVERSEAS SERVICE DEPT. MITSUBISHI MOTORS CORPORATION

SERVICE BULLETIN		No.: MSB-97E42-502	
		Date: 1998-03-31	<Model> GALANT (EA0) <M/Y> 97-10
Subject: CORRECTION TO LICENCE PLATE LAMP GARNISH REMOVAL AND INSTALLATION			
Group: BODY	Draftno: 97-JY-027		
CORRECTION	OVERSEAS SERVICE DEPT	 R. USAMI - MANAGER QUALITY INFORMATION ANALYSIS	

1. Description:

This Service Bulletin informs you of correction to the license plate lamp garnish removal and installation.

2. Applicable Manuals:

Manual	Pub. No.	Language	Page(s)
'97 GALANT Workshop Manual chassis	PWDE9611	(English)	42-4
	PWDS9612	(Spanish)	
	PWDF9613	(French)	
	PWDG9614	(German)	
	PWDD9615	(Dutch)	
	PWDW9616	(Swedish)	

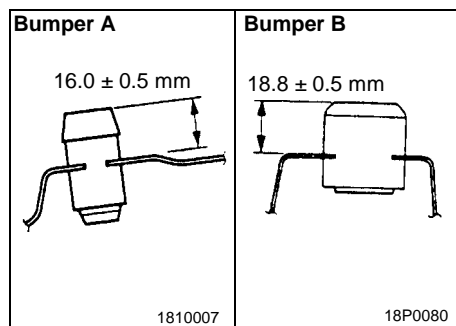
**INSTALLATION SERVICE POINT****►A◄ BUMPER B/BUMPER A INSTALLATION**

Install the bumper A and B as shown in the installation.

<Correct>

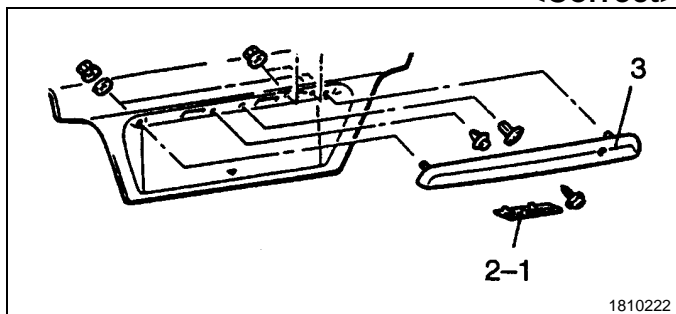
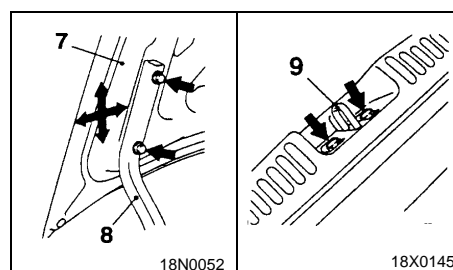
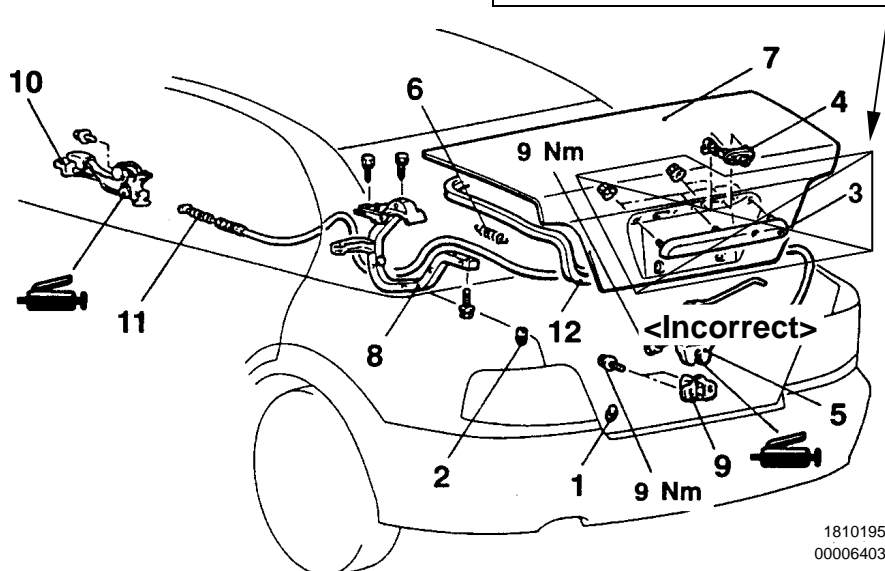
**TRUNK LID <SEDAN>
REMOVAL AND INSTALLATION**

Adjustment of clearance around trunk lid and trunk lid striker linkage.

<Added>

2-1. Cover

Trunk lid panel removal steps

- B◄
►B◄
1. Bumper A
 2. Bumper B
 - Licence plate lamp
 3. Licence plate lamp garnish
 4. Trunk lid lock cylinder
 5. Trunk lid latch
 - Spring cover (Refer to GROUP 52A - Trims)
 6. Trunk lid hinge spring
 7. Trunk lid panel

Trunk lid hinge removal steps

- Rear shelf trim (Refer GROUP 52A - Trims)
- 7. Trunk lid panel
- 8. Trunk lid hinge

Trunk lid latch removal

- 5. Trunk lid latch

Trunk lid striker removal steps

- Rear end trim (Refer to GROUP 52A - Trims)
- 9. Trunk lid striker

Trunk lid release handle and cable removal steps

- Front seat (driver's side) (Refer to GROUP 52A)
- Rear seat (Refer to GROUP 52A)
- Front scuff plate (driver's side) (Refer to GROUP 52A)
- Rear scuff plate (driver's side) (Refer to GROUP 52A)
- Trunk room side trim (driver's side) (Refer to GROUP 52A)
- 5. Trunk lid latch
- 10. Trunk lid release handle
- 11. Trunk lid release cable

Trunk lid weather-strip removal

- A◄ 12. Trunk lid weather-strip removal